

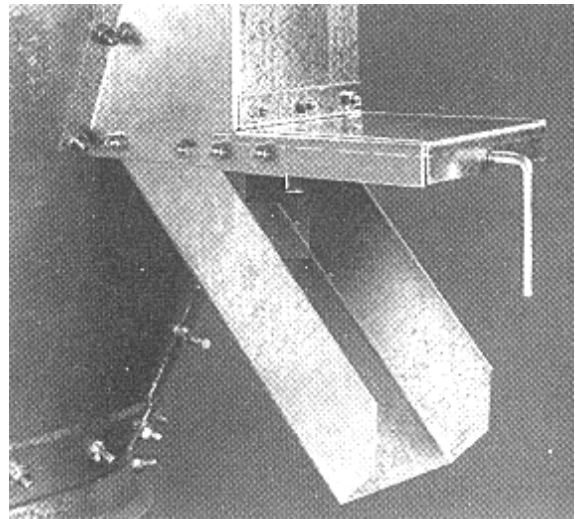

HOPPER VALVE KIT 3-29655 Assembly Instructions

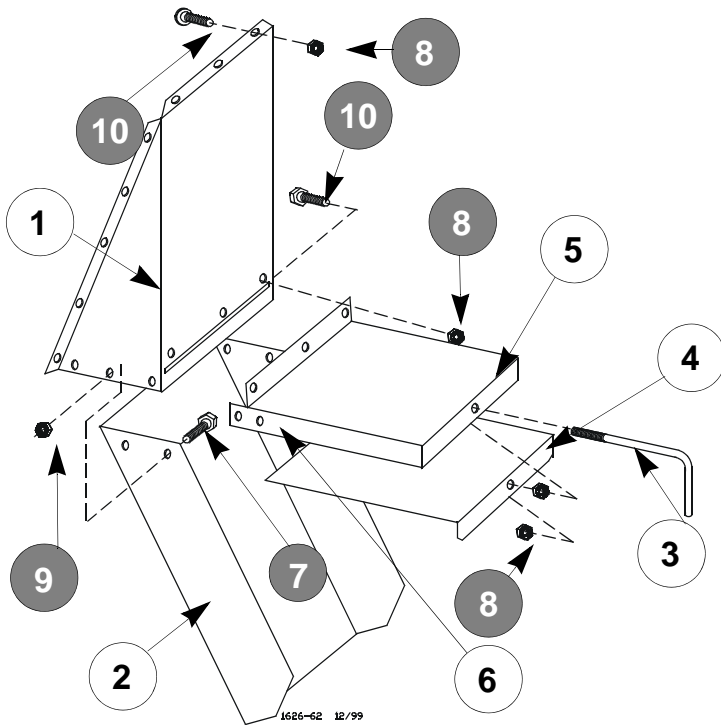

Item	Part No.	Description	Qty.
1	3-29626	Hopper Adapter Plate	1
2	3-29627	Hopper Valve Outlet Guide	1
3	3-29630	Hopper Valve Handle	1
4	3-29629	Hopper Valve Slide	1
5	3-29628	Hopper Valve Shield	1
6		A lock-out device may be installed here.	
	13-35751	Hopper Valve Mounting Template (not shown)	1
Hopper Valve Hardware Bag - 3-29663			
7	39-20002	1/4" x 12" Hex Head Bolt	6
8	39-20020	5/16" Hex Nut	18
9	39-20019	1/4" Hex Jam Nut	6
10	39-20145	5/16 x 3/4" Truss Head Bin Seal Gr. 8.2 Bolt	16

The Hopper Valve should be mounted no higher than **halfway up** the Hopper Panel.

1. Use the Hopper Valve Mounting Template as a guide and mark the mounting hole locations.
2. Drill holes 3/8" [9.5 mm] diameter at the locations marked.
3. Cut a rectangular access hole 11 x 4 1/2" [279.4 x 114.3 mm] 3/4" [19.1 mm] inside the Bolt holes, using a sabre saw with a fine-tooth blade for metal. (Do not use a cutting torch or grinding wheel as they may damage protective galvanization.)
4. Assemble the Shield, Handle, and Outlet Guide to the Hopper Adapter Plate as shown above.
5. Caulk on both sides of the Bolt holes and corners.
6. Attach the Valve Assembly to the Hopper with the Hardware provided.